

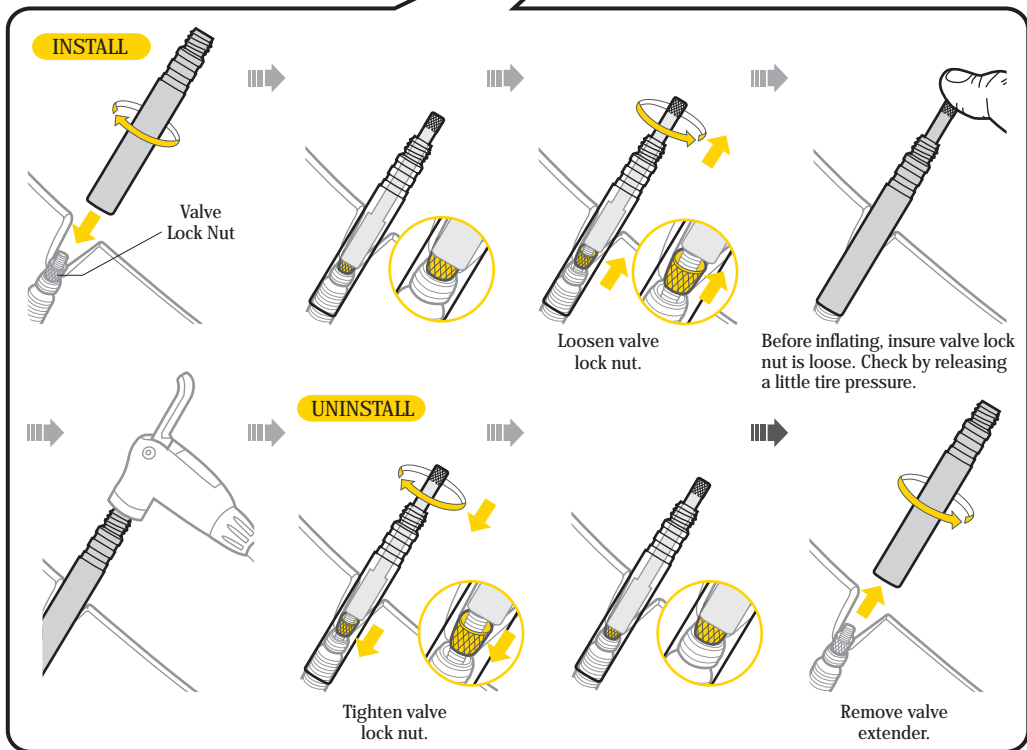

PRESTA VALVE EXTENDER

User's Guide

GB

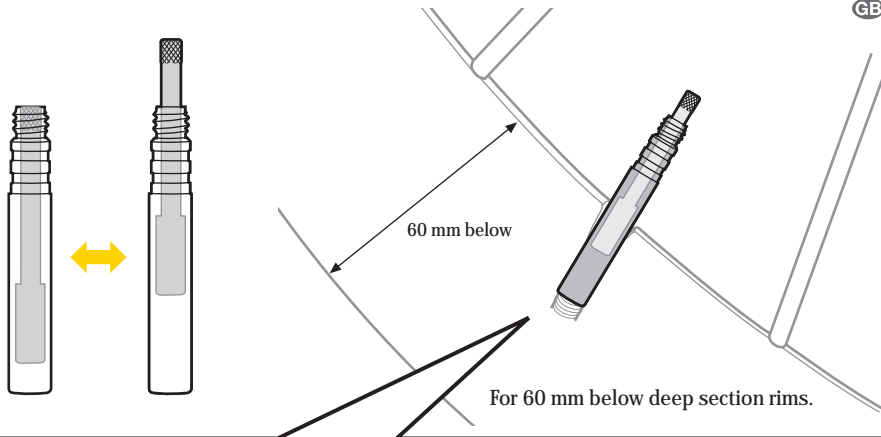

LIMITED WARRANTY

2-year Warranty: All mechanical components against manufacturer defects only.

Warranty Claim Requirements

To obtain warranty service, you must have your original sales receipt. Items returned without a sales receipt will assume that the warranty begins on the date of manufacture. All warranties will be void if valve extender is damaged due to rider crash, abuse, modification, or used in any way not intended as described in this operating manual.

* The specifications and design are subject to change without notice.

Topeak products are available only from professional bicycle shops.

Please contact your nearest Topeak authorized bicycle dealer for any questions.

Website: www.topeak.com

Copyright © Topeak, Inc. Printed in Taiwan / 2006

M-TFV02-GB 5/06